

UVC40 E2 Datasheet

All-in-One USB Video Bar for Small and Huddle Room

Yealink UVC40 E2 is an all-in-one intelligent USB meeting device for small and huddle rooms. Featuring 4K ultra-HD imaging and 120° uper-wide-angle lens, UVC40 E2 delivers outstanding video quality. Together with the electric lens cap, its AI technologies including Auto Framing, sound localization, Speaker Tracking, and so on allow users to experience a smarter and safer video conference. With 8 MEMS microphone arrays and a high fidelity speaker, UVC40 E2 brings excellent call quality even in full-duplex mode. Additionally, it offers the option to expand the conference room boundaries with wireless or wired microphone extensions, enhancing the versatility of its usage. Moreover, UVC40 E2 supports remote management on the Yealink Device Management Platform via a wired network.

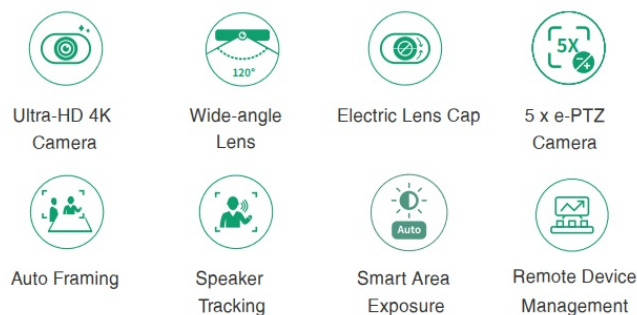

Key Features and Benefits

- Ultra-HD 4K Camera
- Super-Wide 120° Field of View
- Electric lens cap
- Built-in 8 MEMS microphone arrays
- Wireless/wired expansion microphone
- Wired network, remote device management
- Auto Framing and Speaker Tracking
- Applicable to most popular video conferencing Platforms

Ultra-HD 4K Camera| Super-Wide 120° Field of View| Smart Area Exposure

1/1.8-inch CMOS ultra-HD 4K lens, clear and smooth video calls, vivid and detailed presentation. The 120° ultra-wide view easily covers every corner of the meeting room, capturing all participants. smart area exposure enhance overall brightness through AI image algorithms for better face and picture presentation.

Smart Video Conferencing with AI Technology

Featuring AI technology, including Auto Framing, Speaker Tracking, and Sound localization, UVC40 E2 not only supports framing the groups automatically according to the number and the position of the participants, but also automatically zoom in the speaker without adjusting the camera, making the participants more focus on the conference.

Precise Sound Localization, Full-Duplex Experience

8 MEMS microphone arrays make UVC40 E2 E2 have stronger ability of noise proof and dereverberation.

The new upgraded beamforming algorithm, together with technology of processing on acoustic echo cancellation and the dereverberation, brings high-quality full-duplex call and realizes more precise voice pickup. Support an optional wireless/wired expansion microphone to expand the boundaries of the conference room usage while maintaining an exceptional audio experience.

Secure Conference with Electric Lens Cap

The camera's electric lens cap automatically opens when the video conference starts and remains closed when not having video conferences, securing your conference privacy.

Integrated design | Standard UAC/UVC devices | Device management

Compact design for fast deployment, UVC40 E2 E2 includes a wall mount bracket, TV mount bracket, and an optional desktop stand. As a standard UAC/UVC device, UVC40 E2 E2 applies to most video conferencing platforms. Connecting to a wired network, UVC40 E2 E2 can realize remote device management, configuration, diagnosis, and upgrade.

Specifications

Parameter	Description
Package Content	<ul style="list-style-type: none">· UVC40 E2 all-in-one USB video bar· VCR20 Remote Control, 2 x AAA battery· Power adapter· Wall bracket and accessories· TV Mount Bracket and Accessories· 7m USB cable· Desktop Stand (optional)· Velcro· Quick Start Guide· Silicone Pad· Cable Ties
Camera	<ul style="list-style-type: none">· 8MP Camera with SONY 1/1.8-inch CMOS· 120° Ultra-Wide Field of View· 5x e-PTZ camera· Electric lens cap· Camera presets· Video Output Maximum Resolution: 4K30fps
Audio	<ul style="list-style-type: none">· Built-in 8 MEMS microphone array· Signal-to-Noise Ratio: 72dB· Dynamic Range: 22-130dB· Sensitivity: -38dbv/pa· Frequency Response: 50-20kHz· Sampling Rate: 48kHz· Bit Depth: 32bit

Speaker	<ul style="list-style-type: none"> · Built-in 5W High-Fidelity Speaker · Frequency Response: 105-20kHz · Sensitivity: 84dB SPL @ 1W @ 0.5 meter · Sampling Rate: 48kHz · Sound emission angle: Forward-facing · Total Harmonic Distortion (THD): at 5W, 1kHz, <5% · Rated Impedance: 4 ohms · Rated Power: 5W · Maximum Power: 7W
Audio Codec and Technology	<ul style="list-style-type: none"> · Intelligent Noise Cancellation Technology (Yealink Proprietary) · Noise Suppression · Echo Cancellation · Acoustic Echo Cancellation · Automatic Lip Sync Detection · Automatic Gain Control · Full-Duplex Technology
AI Technologies	<ul style="list-style-type: none"> · Auto Framing · Speaker Tracking · Smart Area Exposure
System Requirement	<ul style="list-style-type: none"> · Windows 7, Windows 10, Mac OS 10.10 or Higher · Support for standard audio and video device drivers - UAC1.0 - UVC1.0
Physical Interfaces	<ul style="list-style-type: none"> · 1 x USB3.0 Type-B port · 1 x USB2.0 Type-A port · 1 x Yealink microphone port (RJ-45, it can be switched to Ethernet connection for wired network connectivity) · 1x 3.5mm Line-in port · 1 x Power port (48V/0.7A) · 1 x Security lock slot · 1 x Reset slot · Built-in Wi-Fi
Manageability	<ul style="list-style-type: none"> · Yealink RoomConnect management tool · Yealink Management Cloud Service/Device Management Platform
Power Supply	<ul style="list-style-type: none"> · Power Consumption - Average: 10.5W - Peak: 12.428W - Standby: 9.56W · Power Adapter: AC 100~240V Input, DC 48V/0.7A Output · USB Output: 5V · Supports PSE: 48V Output

Compatibility	<ul style="list-style-type: none">· UVC40 E2 is applicable to most video conferencing platforms, including but not limited to the following:- Microsoft Teams- Zoom Room
Product Feature	<ul style="list-style-type: none">· UVC40 E2: 600 mm x 68 mm x 82 mm· Weight:1.37 kg N.W/CTN: 13 Kg· Wall Bracket: 127.5 mm x 143 mm x 82 mm
Package Feature	<ul style="list-style-type: none">· Giftbox Size: 674mm x 136mm x195mm· Carton Size: 685mm x 290mm x 397mm· N.W/CTN: 13 Kg· N.W/CTN: 14 Kg· Quantity:4
Other Physical Features	<ul style="list-style-type: none">· External Yealink Power Adapter: AC 100~240V input and DC 48V/0.7A Output· Operating humidity: 10 - 95%· Operating temperature: 0 - 40°C· Storage temperature: -30°C~70°C

UVC40 E2 Installation

Package Contents

TIP

- We recommend that you use the accessories provided or approved by Yealink. The use of unapproved third-party accessories may result in poor performance.
- Use the Yealink original power adapter (48V/0.7A) to charge the endpoint only. The use of the third-party power adapter may cause the damage to the endpoint.

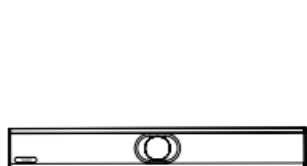

UVC40 E2

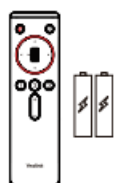

VCR20 Remote Control



(7 m, 22.97 ft)

USB 2.0 (A - B) Cable

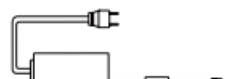

(3.5 m, 11.48 ft)

Power Adapter
(48V/0.7A)



Mounting Bracket



× 2

φ 6*30 mm, white,
Polyamide



× 2

4*30 mm, FAHÖZN3+



× 2

1/4 inch*12 mm



× 1

1/4 inch*13 mm

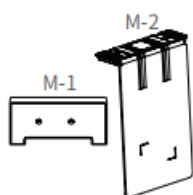

TV-Clip Mount



× 2

1/4 inch*8 mm



× 2

Velcro
(One is on the M-2)

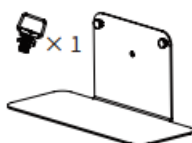

Tabletop Mount
(Optional)



× 5

Cable Ties



× 2

(Φ 38*11.2 mm)

Silicone Pad

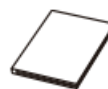

Quick Start Guide

Install UVC40 E2

- Put on a Flat Surface

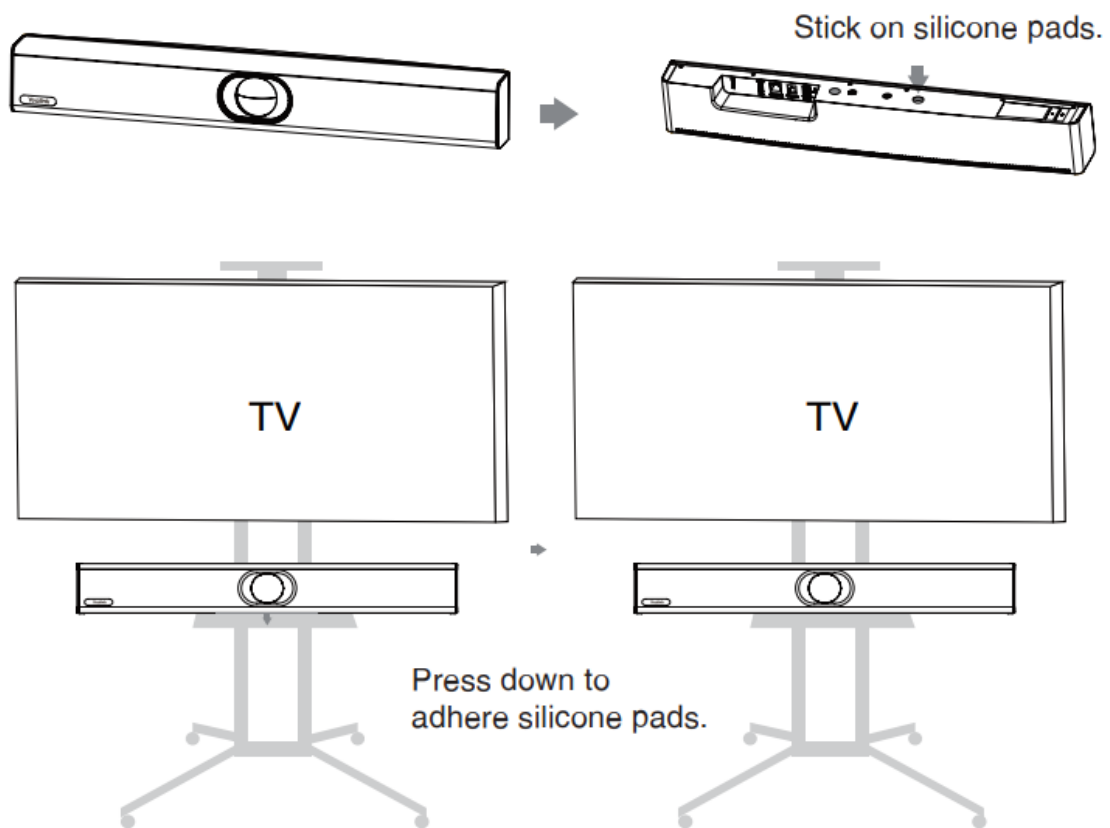

- Mount on a Wall

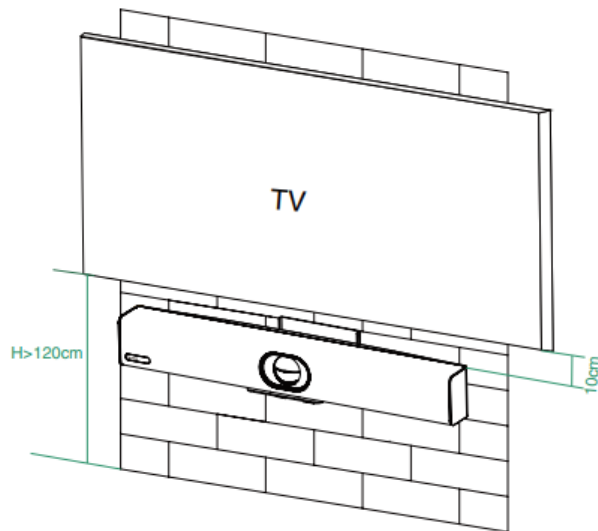

Mount the UVC40 E2 below the TV when the mounting height of the TV is higher than 120cm.

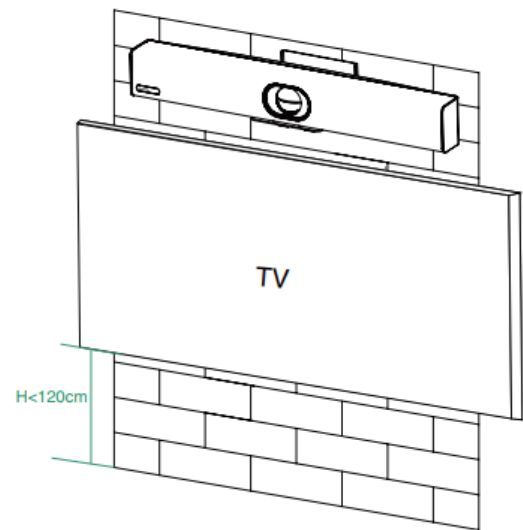

Mount the UVC40 E2 above the TV when the mounting height of the TV is lower than 120cm.

💡 Use the bracket to mount your endpoint on a wall. The mounting height affects your camera view. The recommended height is 1.1m above the ground.

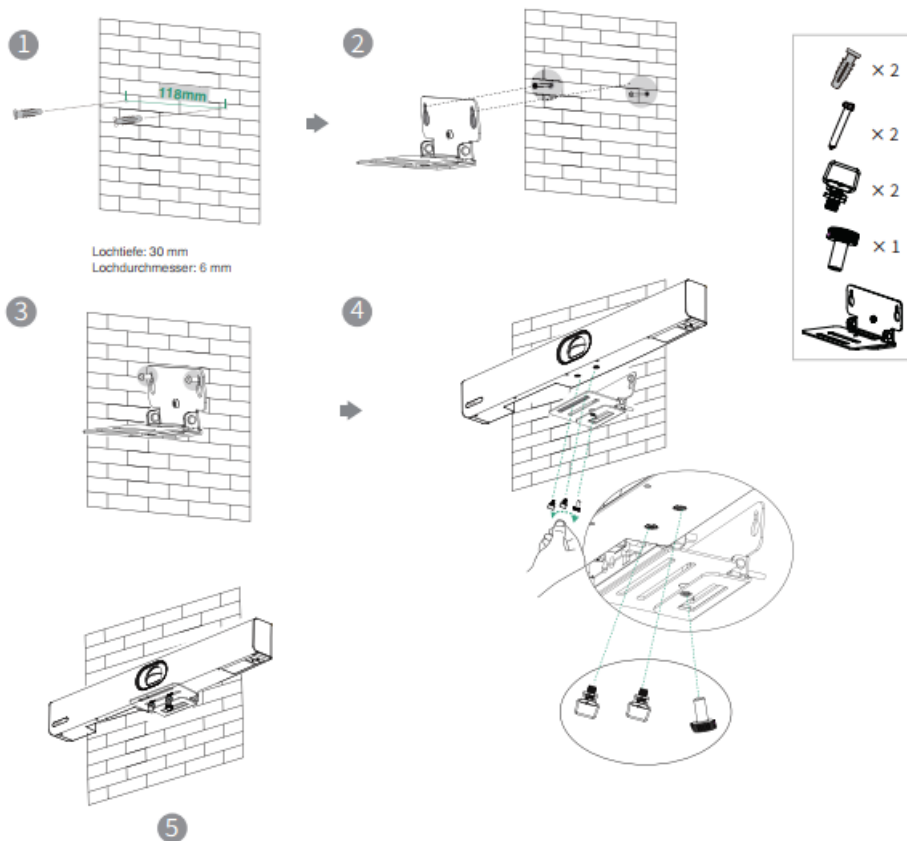

Adjust Camera Tilt

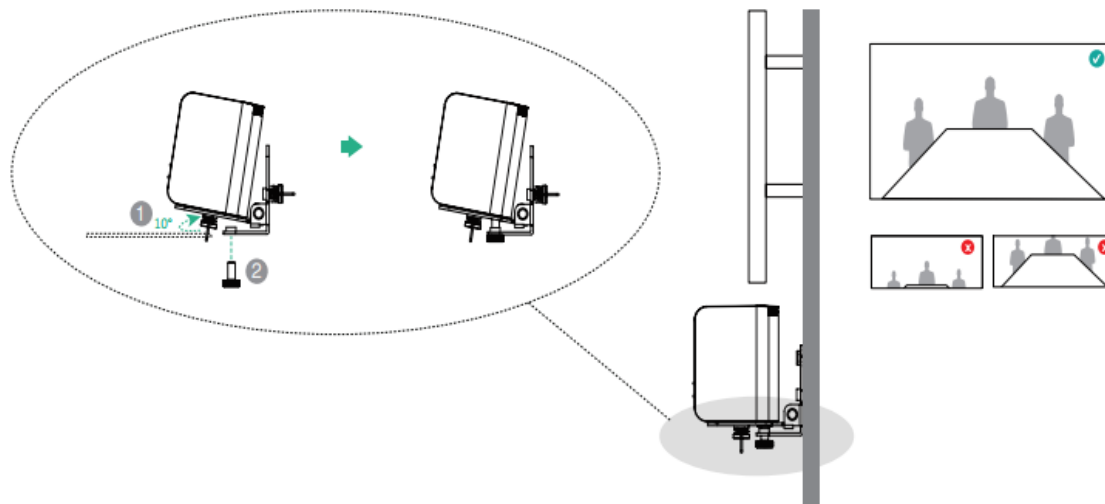

- **mount on the tabletop mount**

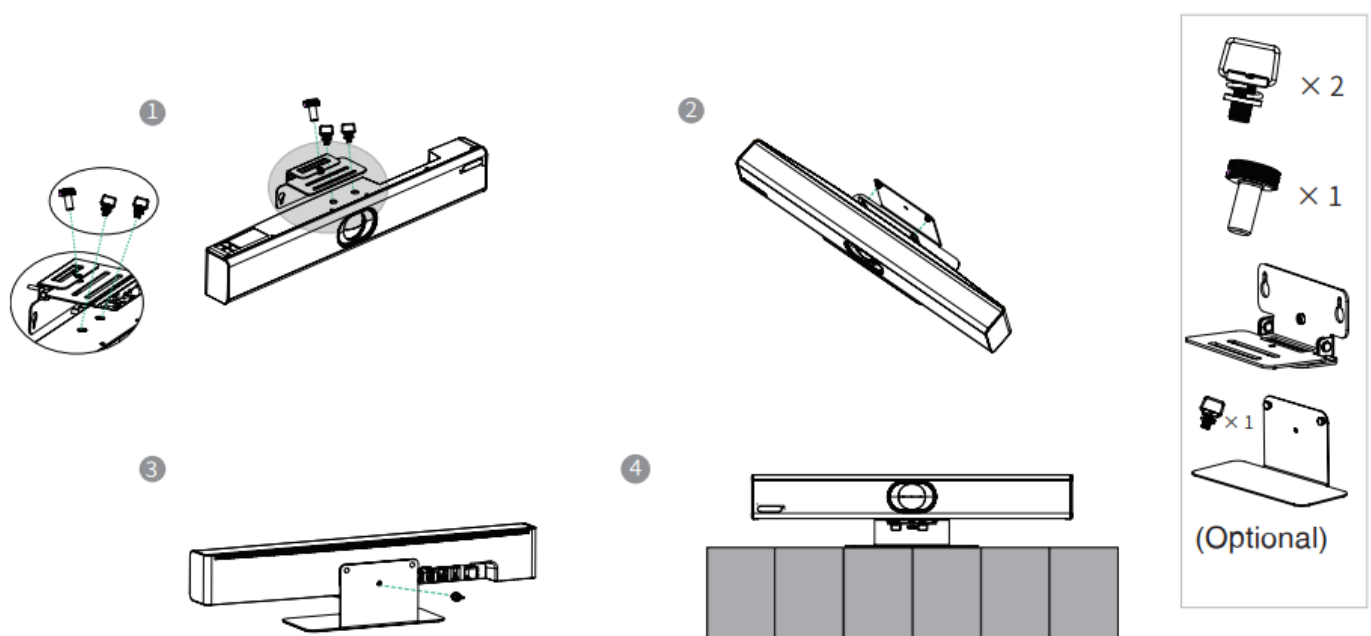

- **mount above a TV or a display**

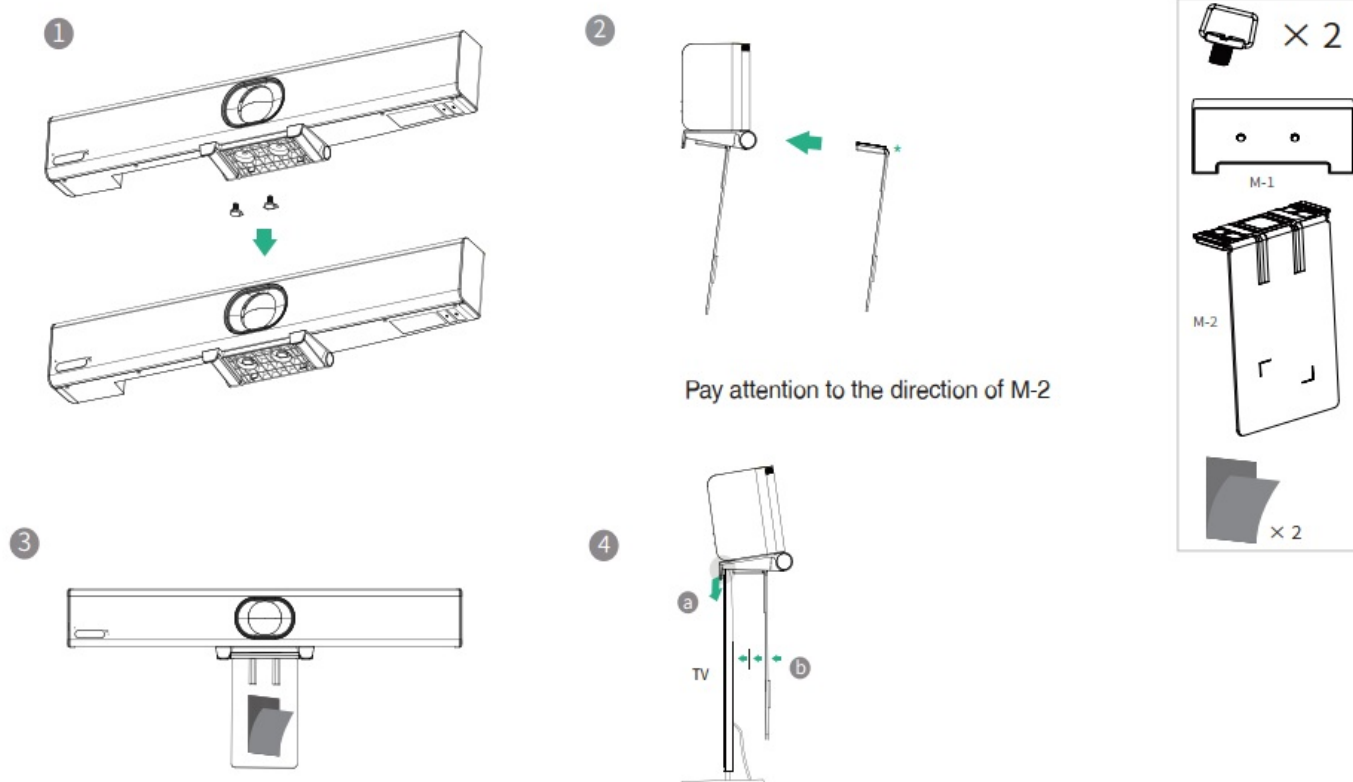

One piece is posted on the inside of M-2 by default

NOTE

The M-2 bracket can be inserted into the M-1 in two directions. Here, we take one direction for example. Due to device weight, it is advisable to avoid mounting the device on slim TVs to prevent potential falls or damage to the screen.

Hardware Interface

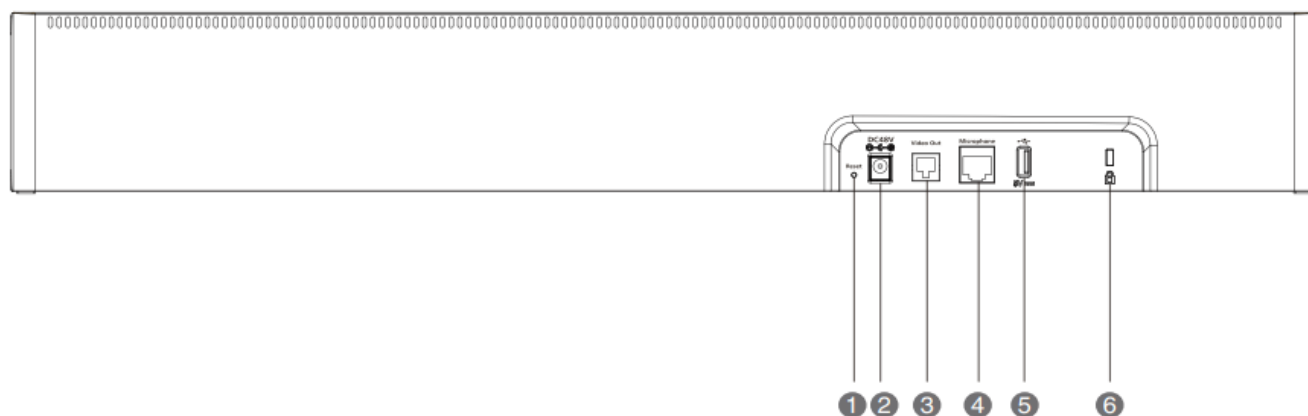

No.	Item	Description
1	Reset	Reset the UVC40 E2 to factory defaults.
2	DC48V	Connect to a power adapter.
3	Video Out	Connect to a PC as video output.
4	Microphone	Connect to Yealink wired microphone (for example, VCM35).
5	USB	Connect to the the Yealink wireless microphone (for example, VCM36-W).
6	Security slot	Connect a universal security cable to the UVC40 E2 so that you can lock the UVC40 E2 down.

Connect UVC40 E2

Connect with VCM35

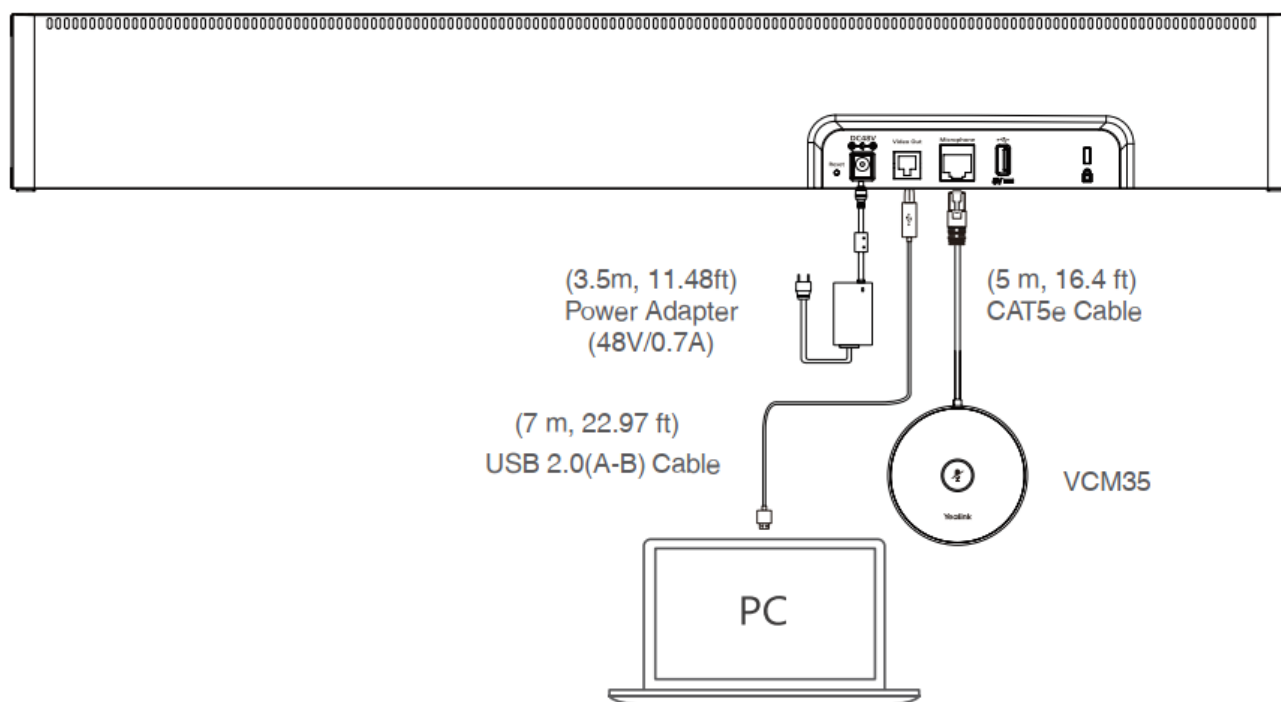

NOTE

When connecting the VCM35, ensure that Network of the UVC40 E2 is disabled on the Yealink RoomConnect (disabled by default, default password: admin). Only then can the VCM35 be utilized.

Connect with VCM36-W

- Pairing directly
1. Connect the USB-C port on the VCM36-W to the USB port on the UVC E2 using the USB (A-C) cable. The Mute LED indicator fast flashes yellow during pairing. Once the flashing ceases, it indicates a successful pairing state. You can also verify on the Yealink RoomConnect software.
 2. Disconnect the cable, then you can use the VCM36-W.

- Pairing by Yealink RoomConnect software
1. Connect the USB-C port on the VCM36-W to the USB port on the PC using the USB-C cable.
 2. Connect the Video Out port on the UVC camera/AVHub to the same PC using the USB-B cable.
 3. Run the Yealink RoomConnect software on the PC. The Mute LED indicator fast flashes yellow during pairing. After paired successfully, the VCM36-W card appears on the Yealink RoomConnect software.
 4. Disconnect the cable, then you can use the VCM36-W.

NOTE

The VCM36-W and the VCM35 can only be used one at a time

LED Indicator

LED Status	Description
Off	The UVC40 E2 is not properly connected to the PC.
Solid green	The UVC40 E2 is active.
Flash green	There is an incoming call.
Solid red	The UVC40 E2 is muted.
Flash red	The UVC40 E2 is in recovery mode and the firmware has not been upgraded.
Solid orange	The UVC40 E2 is initializing or in sleep mode.
Flash orange	The UVC40 E2 is upgrading firmware.
Flash red and green alternately	The UVC40 E2 is paired with the VCM36-W.